

FITTING INSTRUCTIONS

RP4 - Storm Proof Door Seal



HOW TO FIT RP4

For single inward opening doors:

FIG.A (section view)

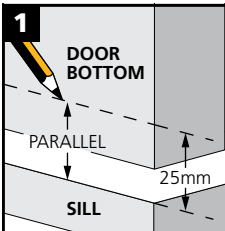
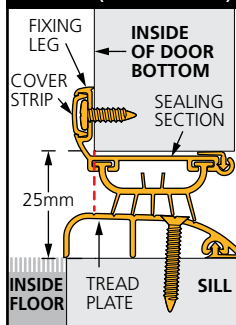

- With door closed, mark line on door bottom, parallel to and 25mm up from door sill.
- Remove door.

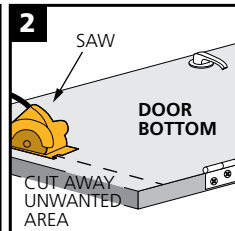

- Saw along marked line.
- Sand and paint the cut end of door to prevent moisture penetration.
- Re-hang door when dry.

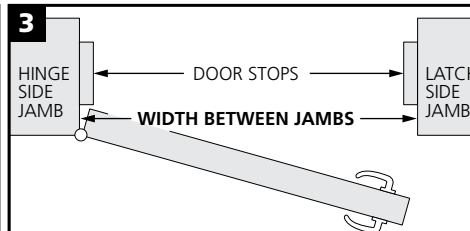

- With a hacksaw, cut tread plate (FIG.A) to full width between jambs.
- With a hacksaw, cut sealing section (FIG.A) to width between jambs less 2mm for clearance on latch side. Cut rubber seals with scissors or a utility knife.

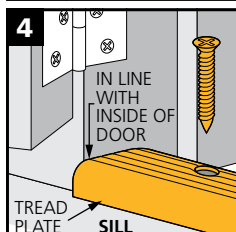

- Position tread plate on sill (FIG.A) and screw fix.
- Apply sealant at ends of tread plate for a better seal.

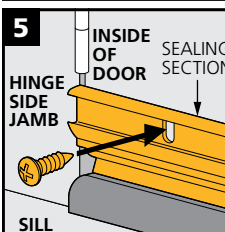

- With door closed, screw fix sealing section to inside of door, hard against hinge side jamb (FIG.A).

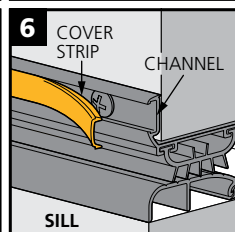

- Cut cover strip to width of sealing section.
- Fit cover strip in channel.

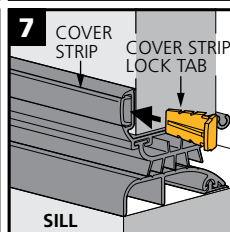

- Push in cover strip lock tabs at each end to hold cover strip. Tap in tabs flush with a small hammer.

FITTING INSTRUCTIONS

RP4 - Storm Proof Door Seal



HOW TO FIT RP4

For single outward opening doors:

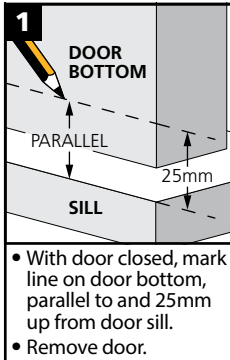
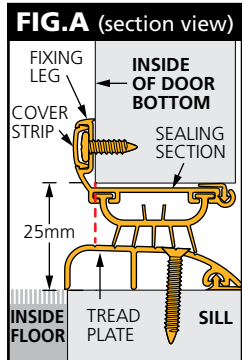

- With door closed, mark line on door bottom, parallel to and 25mm up from door sill.
- Remove door.

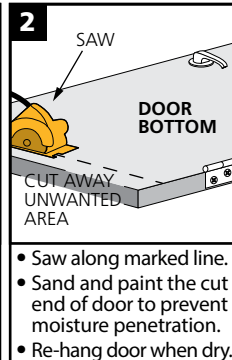

- Saw along marked line.
- Sand and paint the cut end of door to prevent moisture penetration.
- Re-hang door when dry.

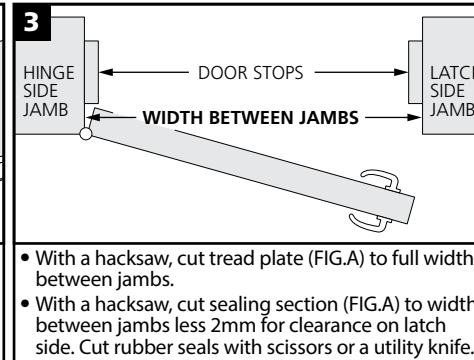

- With a hacksaw, cut tread plate (FIG.A) to full width between jambs.
- With a hacksaw, cut sealing section (FIG.A) to width between jambs less 2mm for clearance on latch side. Cut rubber seals with scissors or a utility knife.

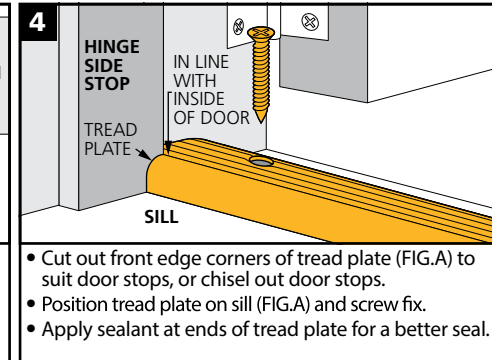

- Cut out front edge corners of tread plate (FIG.A) to suit door stops, or chisel out door stops.
- Position tread plate on sill (FIG.A) and screw fix.
- Apply sealant at ends of tread plate for a better seal.

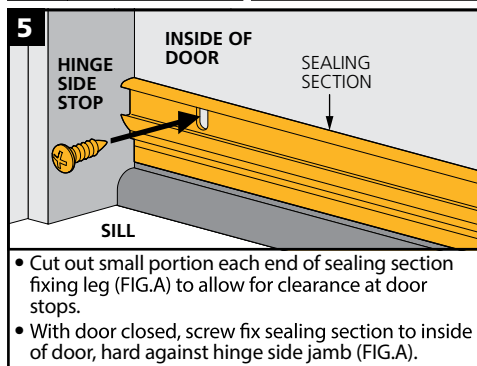

- Cut out small portion each end of sealing section fixing leg (FIG.A) to allow for clearance at door stops.
- With door closed, screw fix sealing section to inside of door, hard against hinge side jamb (FIG.A).

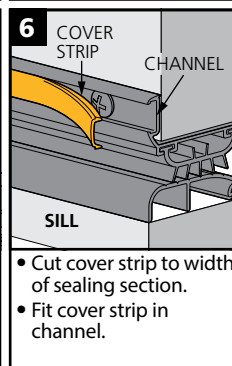

- Cut cover strip to width of sealing section.
- Fit cover strip in channel.

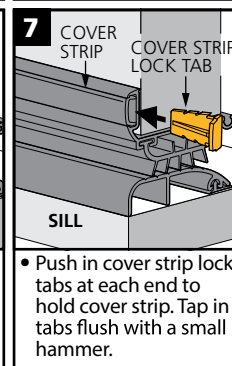

- Push in cover strip lock tabs at each end to hold cover strip. Tap in tabs flush with a small hammer.

FITTING INSTRUCTIONS

RP4 - Storm Proof Door Seal



HOW TO FIT RP4

For double inward opening doors:

FIG.A (section view)

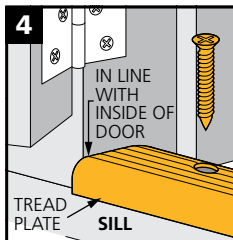
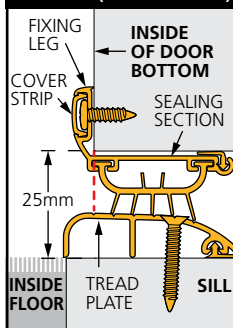

- Position tread plate on sill (FIG.A) and screw fix.
- Apply sealant at ends of tread plate for a better seal.

FIG.B

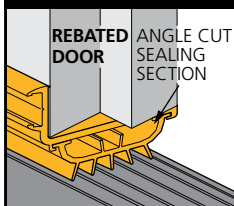

- Cut each sealing section on an angle at the meeting stiles to suit rebate.

PLAN VIEW

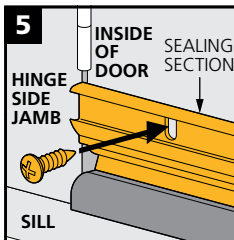
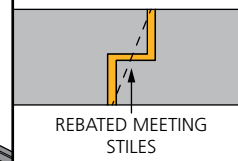

- With door closed, screw fix sealing section to inside of door, hard against hinge side jamb (FIG.A).

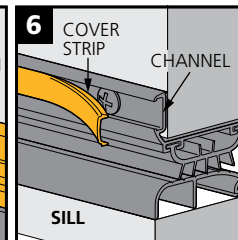

- Cut cover strip to width of sealing section.
- Fit cover strip in channel.

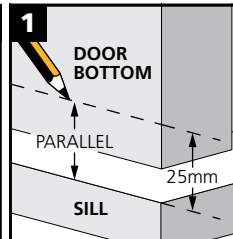

- With door closed, mark line on door bottom, parallel to and 25mm up from door sill.
- Remove door.

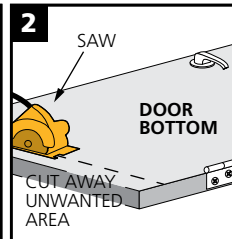

- Saw along marked line.
- Sand and paint the cut end of door to prevent moisture penetration.
- Re-hang door when dry.

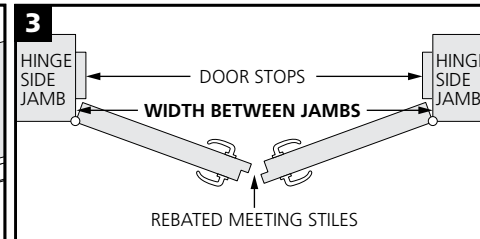

- With a hacksaw, cut each tread plate (FIG.A) to half the width between jambs.
- With a hacksaw, cut each sealing section (FIG.A) to half the width between jambs. Angle cut for rebated meeting stiles (FIG.B).

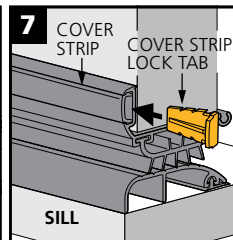

- Push in cover strip lock tabs at each end to hold cover strip. Tap in tabs flush with a small hammer.

FITTING INSTRUCTIONS

RP4 - Storm Proof Door Seal



HOW TO FIT RP4

For double outward opening doors:

FIG.A (section view)

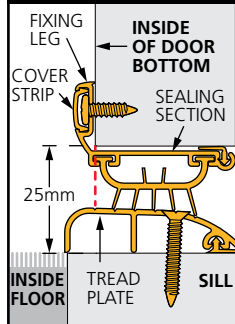
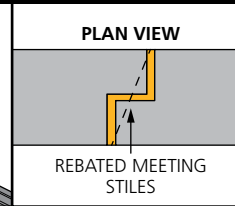
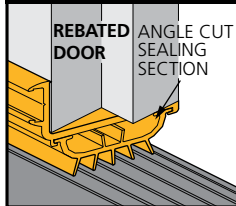
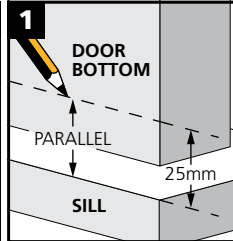

FIG.B



- Cut each sealing section on an angle at the meeting stiles to suit rebate.



- With door closed, mark line on door bottom, parallel to and 25mm up from door sill.
- Remove door.

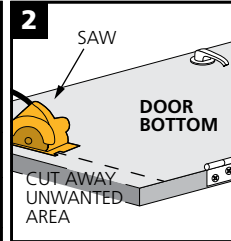

- Saw along marked line.
- Sand and paint the cut end of door to prevent moisture penetration.
- Re-hang door when dry.

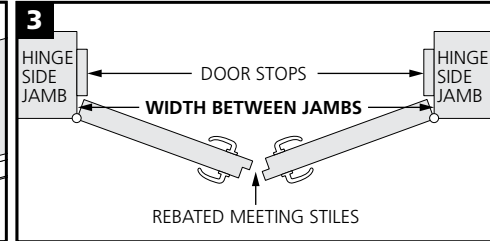

- With a hacksaw, cut each tread plate (FIG.A) to half the width between jambs.
- With a hacksaw, cut each sealing section (FIG.A) to half the width between jambs. Angle cut for rebated meeting stiles (FIG.B).

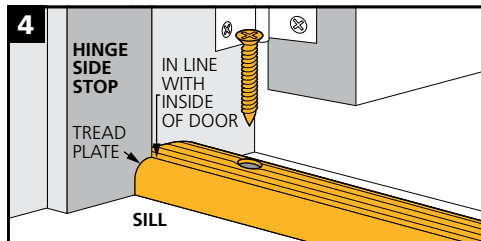

- Cut out front edge corners of tread plate (FIG.A) to suit door stops, or chisel out door stops.
- Position tread plate on sill (FIG.A) and screw fix.
- Apply sealant at ends of tread plate for a better seal.

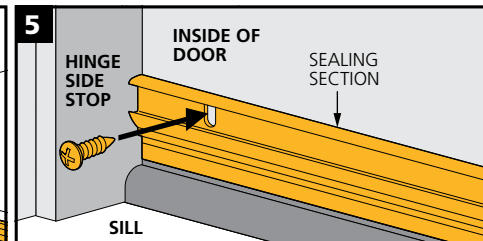

- Cut out small portion each end of sealing section fixing leg (FIG.A) to allow for clearance at door stops.
- With door closed, screw fix sealing section to inside of door, hard against hinge side jamb (FIG.A).

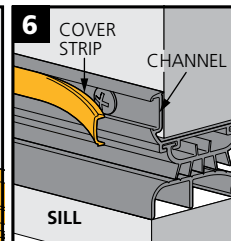

- Cut cover strip to width of sealing section.
- Fit cover strip in channel.

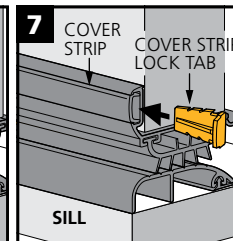

- Push in cover strip lock tabs at each end to hold cover strip. Tap in tabs flush with a small hammer.